



FRIENDS OF ESALEN

n e w s l e t t e r

To Begin Again and to Remember Why

Since 1962, Esalen has been a place where transformative practice has been studied and embodied. Mostly, however, it has been the people who have come through Esalen who have been the objects of transformation. Now, in an ironic twist of fate, the transformational gaze has turned in upon itself and Esalen itself is what stands at the brink.

We must begin again and remember why.

*Albert Wong
Friends of Esalen*

BUILDING THE REDWOOD BATHS

CREATING A SPACE WITH HEART

It was a wild ride.

— Torrey Waag, describing the process of building Esalen's temporary redwood tubs

A crack began developing in the north side trough of the baths in late April — the delayed aftershock of a February mudslide and months of relentless rainstorms. The baths, which we had hoped to salvage, could not be. The foundation was moving. By midnight, Tuesday, April 28, 1998, the Esalen community made their final

farewells. The world's most famous cliffside hot springs were closed.

Though the baths were unusable, the springs still flowed. Plans to build a temporary bathhouse facility fed by the same hot springs source began immediately. Maintenance Manager **Tom Brenner**, architect and craniosacral practitioner **Ned Callihan**, and In-House Education Coordinator **Torrey Waag** cojointly headed the project. "Those of us who were involved in the

Continued on page 2

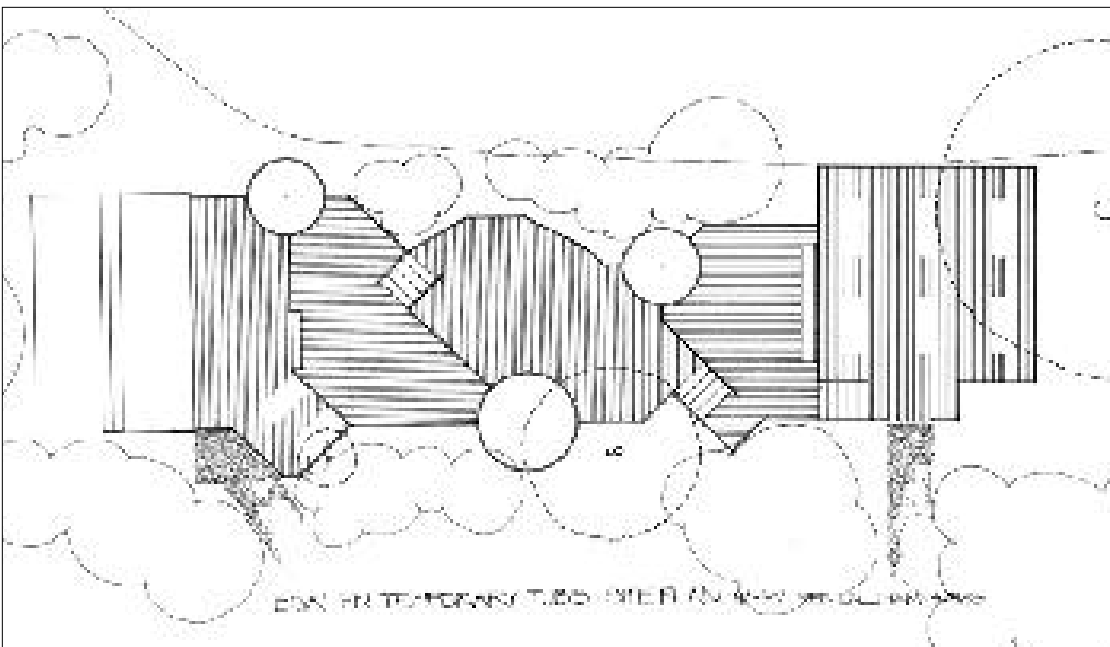

The new baths are a five-level tiered redwood structure set on a cliffside two hundred feet above the ocean. They feature three large redwood tubs (two eight feet in diameter and one ten feet), two individual clawfoot tubs (lower left), a massage deck (far right), and a changing area with showers overlooking the ocean (far left). Oceanside is upwards in the sketch.

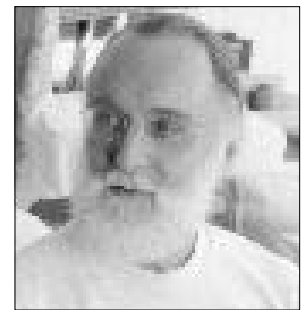

An architectural design sketch of the temporary tubs courtesy of local architect and craniosacral practitioner **Ned Callihan** (above).

"This project really had a life of its own," says Ned. "And I had to listen to the site and pay attention to it rather than try and control it." Ned drafted and redrafted design sketches daily as the baths project evolved.

Beginning Again with the Esalen Baths

BUILDING THE REDWOOD BATHS

CREATING A SPACE WITH HEART

Continued from page 1

project just worked as hard as we had to,” recalls Ned. “And there were ten to twelve-hour days for a number of days in a row.”

An Esalen maintenance team led by **David Nelson, Rocky Baird, and Bill Crain** quickly devised an octopus of plumbing at the oceanside spring site to pump the hot spring water up to a 1,500 gallon insulated holding tank two hundred feet above the old baths. With the help of nuclear physicist **Bob McGinnis** they sidestepped a pipeline backpressure obstacle that threatened to breach the spring’s source. At the same time, **Frank Pinney’s** construction team began laying down a 6’ x 6’ foundational base structure, as Ned was hard

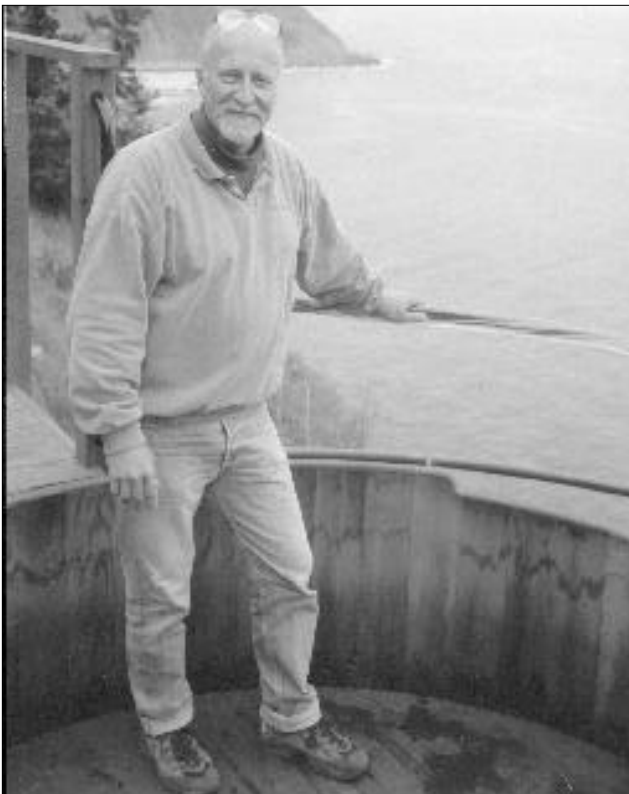

The head of the Maintenance Department, **Tom Brenner** (above), brought years of construction experience to the temporary bathhouse project. Here, he stands in the outermost redwood tub just days before the baths were opened. **Carolyn Moeller** (right), a Work Scholar apprentice in the Garden, enjoys a soak in Esalen’s new ten foot tub.



Peter Littlejohn, an Esalen Staff member on the Maintenance Crew, works to finalize the electrical system for the new redwood tubs.

at work drafting — and redrafting daily — his architectural designs. “We were making five major decisions a day,” stated Torrey. *Should there be two main tubs or three? Should they be six feet in diameter or eight or ten? Would they have to be fiberglass or could we make them redwood?*

The project was completed on the fly in two months from start to finish. “I have never before been involved in a project where the design, construction,

and permits part of a job were taking place at essentially the same time,” says Ned. “It was really a matter of [Torrey] being in the Monterey Planning and Building department saying that we have a structure that’s almost completed, could we have the permits please.”

The temporary baths are done and are beautiful. They will tide

Reconstructing the Old Baths

Plans are currently underway to rebuild the original baths on site down by the ocean. **Mickey Muenig**, an architect known for his fine aesthetic eye, has been chosen as the principle designer and has delivered preliminary architectural sketches. The Project Manager is **Torrey Waag**

The project is complex and will require slope stabilization below the Fritz building prior to actual construction. Torrey describes the building process at the oceanside site as much more akin to building a bridge than building a typical bathhouse. “There’s hot spring water bubbling up out of the foundation,” he explains. The current estimated costs are around \$2 million for both slope stabilization below Fritz and the reconstruction of the bathhouse. Optimistic estimates set the completion time at approximately two years.

us over until the new baths are reconstructed at their original site. In the interim, we invite you to come and soak in these redwood tubs while they are here. They come with all our good intention.

Special thanks to the Monterey Building and Planning Commissions for making this possible with such good will and godspeed. And of course, this structure would not have been possible without the support of the many of you who gave so generously to our storm damage relief fund.



Starting Over with the Help of Friends

*If you put ten candles in a room,
though their bodies are separate
their light is one.*

— Kabir Helminski

The damage from the storms has been great. So too has the outpouring of support from the worldwide Esalen community.

In the nine months since the storm began we have raised \$504,000 to help with the general restoration of Esalen in the wake of El Niño.

These funds come at a particularly crucial time. With our Rolf units damaged, we can operate only at eighty percent capacity and in spite of our best efforts to curtail expenses, our budget forecasts predict a \$340,000 operating loss for the coming year.

Construction projects and emergency relief costs necessitated by the storm damage have come to \$268,000 thus far. Luckily, with the contributions that so many of you have given, we have been able to begin our long process of reconstruction without breaking into our line of credit.

Perhaps the most daunting task, however, still lies ahead of us. Rebuilding the oceanside baths with hillside stabilization under Fritz is currently estimated to cost \$2 million. Rebuilding Rolf will cost approximately \$750,000.

We deeply appreciate all the love and support that you have given us in the past and thank you for walking with us on this long road ahead.

A financial breakdown of storm related damages and donations follows on page four.

FOUNDERS CIRCLE

gifts of five thousand dollars or more

Rhonie Berlinger
Robert Burnett and Kathleen Barry
John Densmore and Leslie Neale
Marcelle Hearst
Jack Lin
Butler Family Fund
Roy A Hunt Foundation
Not Just Us Foundation



Jules Cochrane from Esalen's Maintenance Crew (left) and **Timothy Krech** the foreman on Frank Pinney's construction crew (right), stand side by side at the construction site.



David Nelson from Esalen's Maintenance Crew works on the pipe insulation for the 1,500 gallon holding tank at Porter's Yurt.

GROUP 2000

gifts of two thousand up to five thousand dollars

Ann Griffith Ash
Verena Baier
Richard Fenker
Andrew Hixon
and Michelle Martinez-Hixon
Kristayani and Jerry G Jones
Karen Lehrer and Steven I Sherwin
Maureen McKenna
Jill Moore
Dody Nesbit
Burt Schnierow
Jeremy Tarcher and Shari Lewis (in memoriam)

BENEFACTORS

gifts of one thousand up to two thousand dollars

Ralph Alpert	Charles Hitt
Ed Bassett and Lillian Jones	Jophe Jones
Marta Bennett	Volker Karrer
Wendy Bradach	Don McLucas
Julianne D Bresciani	Frank Marino
Verena S Brunner	Kathy A Mull
Melody Bryant and Randy Landau	Kris Nevius
Grant F Chappell	Gary Owens
Robert and Jenny Chartoff	Paul Page
Evelyn Chipman	Ute Perrey
Murray Cohen	Katja Perrey
Harriett Crosby	Karen Scarvie
John Falzetta	Arthur Scharff
Maureen Gaffney and Samuel Wiener	Jon Schreiber
Maureen E Gilbert	Joan Stephanie
Jeff and Jody Gold	Thomas Tudor
Martin Good	Andre Ventresca
Peter Gruber and Patricia Murphv	George Zimmer

SUSTAINING DONORS

*gifts of five-hundred up to
one thousand dollars*

Veronique Aptekman
Bobbie Asher
Paul Balsler
Jenny Beach
Karen Beare
Harold Benjamin
Martin Berger
Andrew Berlin
Cheryl Best
Wendy Brooks
Judie B Brown
Ursula Brunner
Virginia Coyle
Christine Davis-Goff and Wayne Widdis

Lucy Egg
Margaret Farrell
Carolyn Grant Fay
Harve A Ferrill
Otto Graham
Thomas Hardy
Albrecht R Josephy
Sharon King
Mary Ann Langworthy
J Patterson Lawson
Nina Liff
Marianna Love
John Lowney
Masao Maki

Carole Milligan
Judy L Nantau
Patricia G Norman
Justo Montero Ponce de Leon
Lyle S Poncher
Andreas Reinhart
Marius Robinson
Babette Rose
Paul Rowe
Margie Shackelford
Madeline Sharples
Daniel Snyder
Elmer V Staude
Quinton Wacks
Dennis Wiancko
Zua Wong Wing-Wah
Ken Zeiger

STORM DAMAGE
capital expenditures

El Niño Preparation	3,948
Fences	3,240
Baths	450
Ext /Int Paint Big House	509
Path Lighting	732
2/2/98 Storm Damage	30,167
Main Baths — Post Storm Restoration	23,719
Temporary Tubs — Teepee Area	163,495
Porter's Yurt Restoration	3,268
Canyon & Main Property Waterline Repair	114
Big House Storm Repair	3,188
Tree Cutting	3,195
Main Generator Repair	619
Wood Splitter	1,587
Wells Fargo Bank Statements	11,757
Fritz Carpet	3,760
New Lodge Generator	1,654
Temporary Generator Lease	6,865
Slope Stabilization	5,072
Gazebo School Repair	733
STORM DAMAGE COSTS TO DATE	268,070

— esalen financials —

TOTAL STORM DAMAGE COSTS TO DATE (excluding associated payroll expenses) 268,070	TOTAL STORM DAMAGE RELATED DONATIONS RECEIVED TO DATE
PROJECTED ADDITIONAL STORM DAMAGE	— Storm Damage 492,000
— Main Baths & Slope Stabilization	— Bath Reconstruction Project 12,000
below Fritz & Rolf 2,000,000	TOTAL INSURANCE RECOUPMENT RECEIVED TO DATE 50,000
— Rebuilding Rolf Units 750,000	
TOTAL PROJECTED STORM DAMAGE COSTS 3,020,000	TOTAL STORM DAMAGE FUNDS RECEIVED TO DATE 554,000

FINANCIAL COMMENTARY. The costs listed above do not include loss of business income due to the storms of El Niño (whether from road closure or on-site damage). Importantly, with the Rolf units damaged, Esalen can only operate eighty percent capacity, and in spite of concerted efforts to curtail expenses, the budget forecast predicts a \$340,000 operating loss for the coming year. Note that further insurance recoupment is expected, though it is unclear what total amount the final settlement will come to. In light of the expected operating loss coupled with the need for available capital to proceed with the restoration project, Esalen has taken a loan of \$2.2 million dollars from Wells Fargo Bank at an interest rate of 5.3%.

The storm damage capital expenditure line item notes were taken from a report compiled by Terri Gilbert, Accounts Manager, as also supplied to the Esalen Board of Trustees for their September 9, 1998 San Rafael meeting. The figures for projected further costs are estimates based on conversations with Esalen business consultant Andy Nusbaum and Bath Reconstruction Project Manager Torrey Waag.

